



GUIDE PRICE  
£369,950

Greenways

Winchcombe GL54 5LQ



## THE PROPERTY

\*Sold (stc) by Adams\*

A detached three bedroom bungalow, situated on an established no-through road. The property would benefit from refurbishment throughout and features a mature and private rear garden, driveway parking leading to a garage, a spacious L-shaped sitting and dining room with adjoining conservatory, a kitchen with external door, three bedrooms and a bathroom. Available with no onward chain.

3



1



2



## ADDITIONAL INFORMATION

Mains gas, electricity, water and drainage are connected. Gas central heating via boiler.

Broadband connection and Mobile coverage: Fibre to the property broadband is available to be connected. Mobile signal available - see: [checker.ofcom.org.uk](http://checker.ofcom.org.uk)

## SITUATION

Winchcombe is an ancient Saxon town situated on the famous Cotswold Way about 7 miles north-east of Cheltenham (2hrs to London Paddington by train), 8 miles from Broadway and 16 miles from Gloucester. Many of the houses are listed as being of architectural interest and part of the town lies within the Cotswolds Area of Outstanding Natural Beauty. The thriving local community offers an excellent range of amenities including independent shops, supermarkets, several pubs and restaurants, dental and doctors surgeries, a library, an 'Outstanding' primary school, a secondary school and numerous clubs and societies.



  
ADAMS  
— Estate Agents —





## Greenways, Winchcombe, Cheltenham, GL54

Approximate Area = 890 sq ft / 82.6 sq m (excludes garage)

For identification only - Not to scale

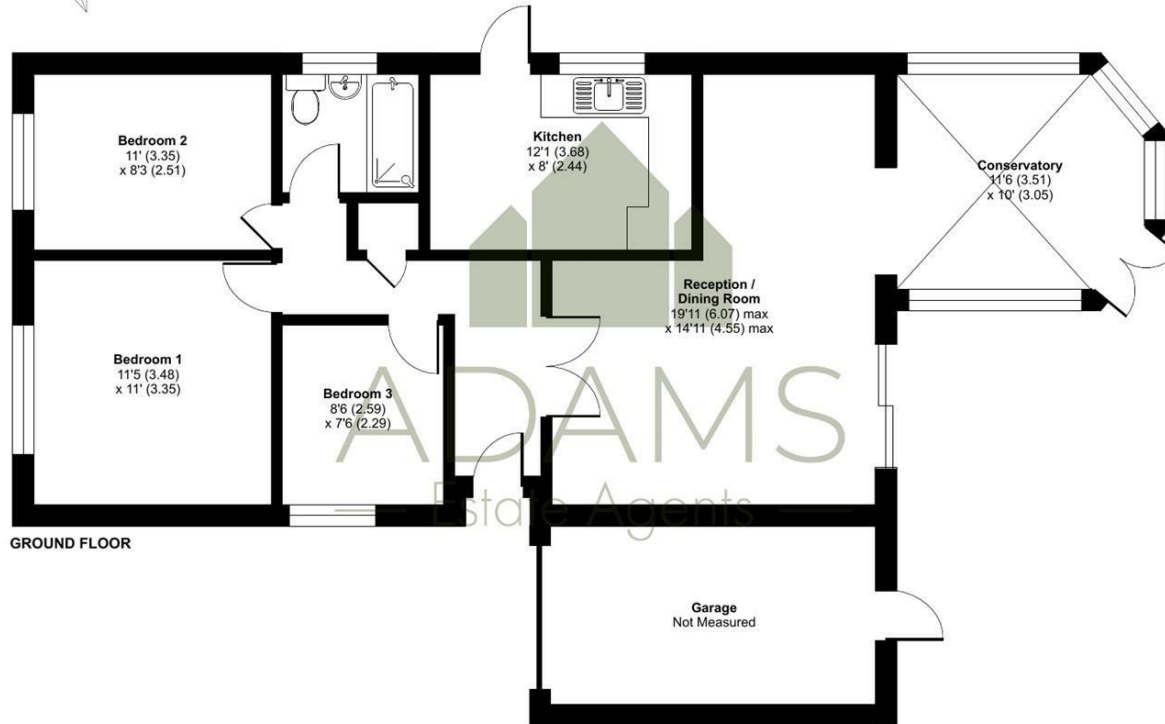

### TENURE

Freehold

### LOCAL AUTHORITY

Tewkesbury Borough Council

### COUNCIL TAX BAND

D

### VIEWINGS

By prior appointment only

Energy Efficiency Rating		Current	Potential
Very energy efficient - lower running costs			
(92 plus) <b>A</b>			
(81-91) <b>B</b>			
(69-80) <b>C</b>			
(55-68) <b>D</b>		67	73
(39-54) <b>E</b>			
(21-38) <b>F</b>			
(1-20) <b>G</b>			
Not energy efficient - higher running costs			
<b>England &amp; Wales</b>		EU Directive 2002/91/EC	

Agents Note: Whilst every care has been taken to prepare these particulars, they are for guidance purposes only. All measurements are approximate and are for general guidance purposes only and whilst every care has been taken to ensure their accuracy, they should not be relied upon and potential buyers/tenants are advised to recheck the measurements

Floor plan produced in accordance with RICS Property Measurement 2nd Edition, Incorporating International Property Measurement Standards (IPMS2 Residential). © nchecom 2025. Produced for Adams Estate Agents Limited. REF: 1312843



#### OFFICE ADDRESS

Hereford House, 20 North Street, Winchcombe, Cheltenham, Gloucestershire, GL54 5PS

#### OFFICE DETAILS

01242 603601  
sales@adamsestateagents.com  
www.adamsestateagents.com